



ASME BPE certified manufacturers
ISO9001 international quality management
system certification.



+ ASME BPE



温州市好博机械有限公司
WENZHOU HOPE MACHINERY CO., LTD

- 地址: 浙江省温州市龙湾区海棠路220号
Add: 220 Haitang Road, Longwan District, Wenzhou, Zhejiang
- Tel: 0086-577-88868068
- Fax: 0086-577-88868065
- Email: info@hopemachinery.com



企业简介+ COMPANY PROFILE



温州市好博机械有限公司成立于2004年，座落在温州经济技术开发区滨海园区，共设3栋厂房，6个车间，总占地面积11600平方。并于2023年成立浙江好博机械有限公司，占地12000平方，主要生产卫生级管道。

我们的主要产品是卫生级管件，管道，阀门，泵。产品按DIN、3A、SMS、ISO、BS、IDF和ASME BPE标准设计生产，并通过ASME BPE认证(证书编号:BPE-181)和ISO9001国际质量管理体系认证。

好博机械致力于卓越的质量、先进的制造技术、良好的客户服务，并于众多国内外知名企业建立了持久、牢固的合作关系。

好博机械秉承“质量优先，诚信为本”的经营理念，致力于打造行业内质量标杆。

Wenzhou Hope Machinery Co., LTD., founded in 2004, is located in Binhai Park, Wenzhou Economic and Technological Development Zone, with 3 plants and 6 workshops, covering a total area of 11600 square meters. In 2023, Zhejiang Hope Machinery Co., Ltd. was established, covering an area of 12,000 square meters, mainly producing sanitary pipes.

Our main products are sanitary pipe fittings, pipes, valves, pumps. The products are designed and manufactured according to DIN, 3A, SMS, ISO, BS, IDF and ASME BPE standards, and have passed ASME BPE certification (Certificate number: BPE-181) and ISO9001 international quality management system certification.

Hope machinery is committed to excellent quality, advanced manufacturing technology, good customer service, and many well-known enterprises at home and abroad to establish a lasting, solid cooperative relationship.

Hope machinery adhering to the "quality first, integrity-based" business philosophy, is committed to creating a quality benchmark in the industry.

HOPE's products are worthy of your trust, and we have certificates that meet stringent standards

HOPE的产品绝对值得您的信任 我们拥有符合严苛标准的证书认证

▼ 温州基地 Wenzhou base



▼ 丽水基地 Lishui Base



我们的优势 + OUR ADVANTAGE



值得信赖的来源: 基于坚实的技术能力
Trustworthy source: based on solid technical capabilities



国际领先的高精度系统 International leading high precision system

我们拥有许多先进的系统，如无损检测、EDD、静水测试系统、机械性能测试系统、晶相分析系统等。为我们的优质产品提供最可靠和有利的保证。

We have many advanced systems such as NDT, EDD, hydrostatic testing system, mechanical property testing system, crystal phase analysis system, etc. To provide the most reliable and powerful guarantee for our quality products.



完善成熟的表面处理工艺 Perfect and mature surface treatment process

根据当前的技术发展，我们自主研发并自主调试了自动抛光设备，以高品质的工艺为您打造最完美的产品。

According to the current technological development, we have developed and commissioned our own automatic polishing equipment to create the most perfect product for you with high quality process.



高效率的固溶技术 High efficiency solid solution technology

采取在线固溶工艺，相比普通的退火工艺，更大限度的改善材料的机械性能和组织硬度，提高管道韧性及抗蚀性能。

Adopt online solid solution process, compared with the ordinary annealing process, to improve the mechanical properties and tissue hardness of the material to a greater extent, improve the toughness of the pipe and corrosion resistance.

先进的全面质量管理体系: 将所有产品和流程做到一流质量
Advanced total quality management system: top quality for all products and processes

- ◆所有工序严格按照流程要求进行，环环相扣，确保成品质量
- ◆产品从原材料开始进行过程质量控制直至最终检验/标记/包装
- ◆所有量具经过国际组织校验，符合国际标准
- ◆保障100%员工质量培训，具有自检意识和流程意识
- ◆提供所有必要的生产过程数据，每个产品具有完整的可追溯性
- ◆所有BPE标准的产品采用全检，确保产品符合ASME BPE标准

- ◆All processes are carried out in strict accordance with the process requirements and are interlocked to ensure the quality of the finished product
- ◆Process quality control from raw materials to final inspection, marking and packaging
- ◆All gauges are calibrated by international organizations and conform to international standards
- ◆Guarantee 100% staff quality training, with self-inspection awareness and process awareness
- ◆All necessary production process data is available and each product has full traceability
- ◆All BPE standard products are fully inspected to ensure that they comply with ASME BPE standard



ASME BPE 管件管道认证制造商
Certified manufacturer of pipe fittings and piping

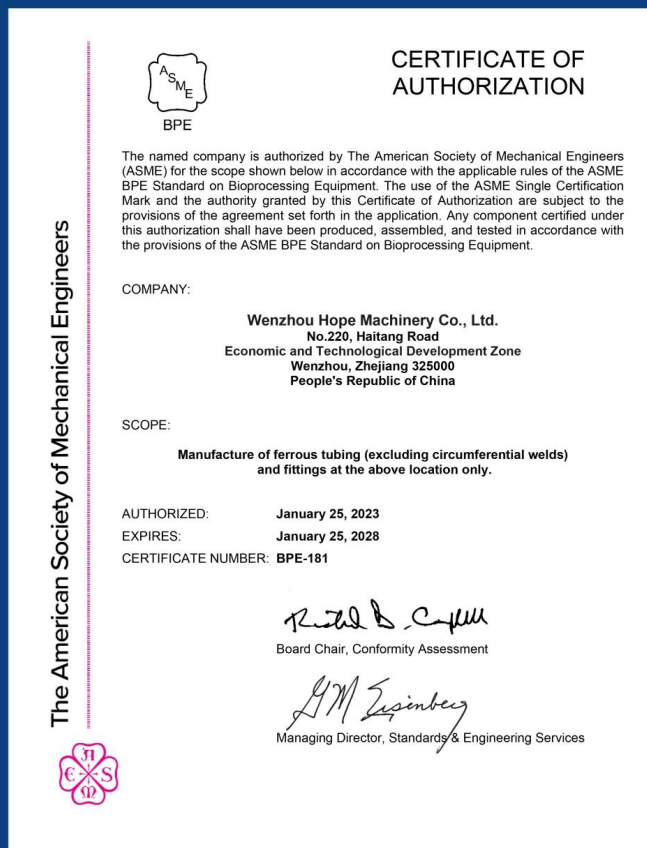

好博机械提供生物技术和制药加工，食品饮料等应用领域所需的专业配件和管件。好博机械高洁净管件采用2B冷轧钢卷为原材料，采用纵向焊接技术实现完全熔透，成熟的焊缝处理技术确保焊接合格。我们的线涡轮探伤系统可以确保每一个产品都没有杂质。在面对CIP清洗，酸洗等工况下，好博机械管件抗腐蚀能力更强。

Hope Machinery provides professional accessories and fittings for biotechnology and pharmaceutical processing, food and beverage applications. The 2B cold-rolled steel coil is used as raw material for the high clean pipe fitting of Hope Machinery. The longitudinal welding technology is adopted to achieve full penetration, and the mature weld processing technology ensures the welding qualification. Our line turbine flaw detection system ensures that every product is free of impurities. In the face of CIP cleaning, pickling and other conditions, Hope mechanical pipe has stronger corrosion resistance.



BPE 管件系列

BPE Pipe Fittings Series



我们的高级洁净管道采用国际领先的水压测试系统，机械性能测试系统，晶相分析系统，严格把控管道尺寸，严格控制公差尺寸。

Our advanced clean pipeline adopts the international leading hydraulic test system, mechanical performance test system, crystal phase analysis system, strict control of pipeline size, strict control of tolerance size.

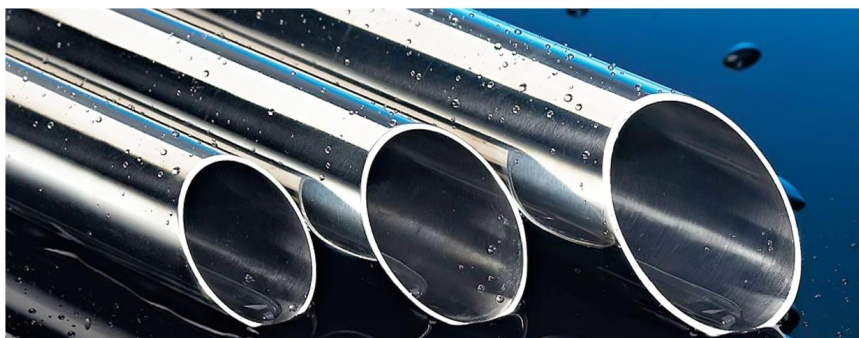

尺寸公差 Dimensional tolerances

规格 OD Size	外径 OD Tolerances	壁厚 Wall thickness	壁厚公差 Tolerances on wall thickness	长度公差 Tolerances on Length	重量 Kg/M Weight
0.5"(12.7)	+/-0.005"(0.13)	0.065"(1.65)	+/-10.0%	+1/8"(3.18)	0.454
0.75"(19.05)	+/-0.005"(0.13)	0.065"(1.65)	+/-10.0%	+1/8"(3.18)	0.717
1"(25.4)	+/-0.005"(0.13)	0.065"(1.65)	+/-10.0%	+1/8"(3.18)	0.976
1.5"(38.1)	+/-0.008"(0.20)	0.065"(1.65)	+/-10.0%	+1/8"(3.18)	1.498
2"(50.8)	+/-0.008"(0.20)	0.065"(1.65)	+/-10.0%	+1/8"(3.18)	2.020
2.5"(63.5)	+/-0.010"(0.25)	0.065"(1.65)	+/-10.0%	+1/8"(3.18)	2.542
3"(76.2)	+/-0.010"(0.25)	0.065"(1.65)	+/-10.0%	+1/8"(3.18)	3.064
4"(101.6)	+/-0.015"(0.38)	0.083"(2.11)	+/-10.0%	+1/8"(3.18)	5.229
6"(152.4)	+/-0.030"(0.76)	0.109"(2.77)	+/-10.0%	+1"(25.4)-0	10.324
8"(203.2)	+/-0.030"(0.76)	0.120"(3.05)	+/-10.0%	+1"(25.4)-0	15.206

好博管件采用在线固溶技术，不锈钢表面光亮，韧性强，不会出现晶间腐蚀现象，焊缝光滑平整，不易开裂，耐腐蚀性好。

Hopo pipe fittings using online solution technology, stainless steel surface bright, strong toughness, no intergranular corrosion phenomenon, smooth weld, not easy to crack, good corrosion resistance.

工艺 Technology	好博BA精品管 Hope BA boutique tube	市面一般的管件 General pipe fittings in the market	
	在线光亮固溶+钝化 Bright solution + passivation on line	大气固溶 Atmospheric solution	无固溶处理 No solution treatment
不锈钢质量 Stainless steel quality	管表面光亮，管道韧性好，内部结构稳定，结晶稳定。 The pipe surface is bright, the pipe toughness is good, the internal structure is stable and the crystallization is stable.	管道发黑 手动抛光处理 含动物油脂，国际禁止 Pipe blackening Hand polishing Contain animal grease, international prohibited	碳化铬析出 结晶混乱 有磁性 耐腐蚀性差 Chromium carbide precipitation Crystal disorder magnetic Poor corrosion resistance
焊缝表面 Pass surface	焊缝平整光滑，确保流体不残留，焊缝表面粗糙度 $\leq 0.8 \mu m$ The weld is smooth and smooth to ensure that no fluid remains. Weld surface roughness $\leq 0.8 \mu m$	焊接有明显突起或者凹陷 液体容易残留，滋生细菌 Welding has obvious protrusions or dents Liquids tend to remain and grow bacteria	焊缝有明显突起或者凹陷 液体容易残留，滋生细菌 Weld path has obvious protrusion or depression Liquids tend to remain and grow bacteria
耐腐蚀性 Corrosion resistance	好Good	差Poor	差Poor
碳含量 Carbon content	$\leq 0.03\%$	$\leq 0.07\%$	$\leq 0.07\%$
钝化膜 Passivation film	厚Lessthick	薄Thin	薄Thin



BPE 管件系列

BPE Pipe Fittings Series

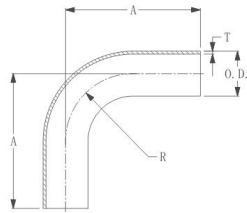

DT-4.1.1-1 焊式90度长弯头 Automatic Tube Weld: 90-deg Elbow

No.		Nom. Size		A	
SF1	SF4	in.	mm	in.	mm
9811-0600-1601	9811-0600-1602	1/4"	6.35	2.625	66.68
9811-0900-1601	9811-0900-1602	3/8"	9.53	2.625	66.68
9811-1200-1601	9811-1200-1602	1/2"	12.70	3.000	76.20
9811-1900-1601	9811-1900-1602	3/4"	19.05	3.000	76.20
9811-2500-1601	9811-2500-1602	1"	25.40	3.000	76.20
9811-3800-1601	9811-3800-1602	1 1/2"	38.10	3.750	95.25
9811-5000-1601	9811-5000-1602	2"	50.80	4.750	120.65
9811-6300-1601	9811-6300-1602	2 1/2"	63.50	5.500	139.70
9811-7600-1601	9811-7600-1602	3"	76.20	6.250	158.75
9811-0100-1601	9811-0100-1602	4"	101.60	8.000	203.20
9811-5200-1601	9811-5200-1602	6"	152.40	11.500	292.10

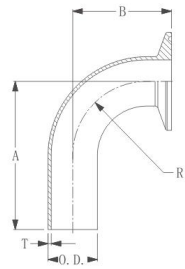

DT-4.1.1-2 单卡90度弯头 Automatic Tube Weld: Hygienic Clamp Joint, 90-deg Elbow

No.		Nom. Size		A		B	
SF1	SF4	in.	mm	in.	mm	in.	mm
9812-0600-1601	9812-0600-1602	1/4"	6.35	2.625	66.68	1.625	41.28
9812-0900-1601	9812-0900-1602	3/8"	9.53	2.625	66.68	1.625	41.28
9812-1200-1601	9812-1200-1602	1/2"	12.70	3.000	76.20	1.625	41.28
9812-1900-1601	9812-1900-1602	3/4"	19.05	3.000	76.20	1.625	41.28
9812-2500-1601	9812-2500-1602	1"	25.40	3.000	76.20	2.000	50.80
9812-3800-1601	9812-3800-1602	1 1/2"	38.10	3.750	95.25	2.750	69.85
9812-5000-1601	9812-5000-1602	2"	50.80	4.750	120.65	3.500	88.90
9812-6300-1601	9812-6300-1602	2 1/2"	63.50	5.500	139.70	4.250	107.95
9812-7600-1601	9812-7600-1602	3"	76.20	6.250	158.75	5.000	127.00
9812-0100-1601	9812-0100-1602	4"	101.60	8.000	203.20	6.625	168.28
9812-5200-1601	9812-5200-1602	6"	152.40	11.500	292.10	10.500	266.70

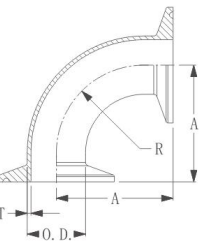

DT-4.1.1-3 卡式90度弯头 Hygienic Clamp Joint: 90-deg Elbow

No.		Nom. Size		A	
SF1	SF4	in.	mm	in.	mm
9813-0600-1601	9813-0600-1602	1/4"	6.35	1.625	41.28
9813-0900-1601	9813-0900-1602	3/8"	9.53	1.625	41.28
9813-1200-1601	9813-1200-1602	1/2"	12.70	1.625	41.28
9813-1900-1601	9813-1900-1602	3/4"	19.05	1.625	41.28
9813-2500-1601	9813-2500-1602	1"	25.40	2.000	50.80
9813-3800-1601	9813-3800-1602	1 1/2"	38.10	2.750	69.85
9813-5000-1601	9813-5000-1602	2"	50.80	3.500	88.90
9813-6300-1601	9813-6300-1602	2 1/2"	63.50	4.250	107.95
9813-7600-1601	9813-7600-1602	3"	76.20	5.000	127.00
9813-0100-1601	9813-0100-1602	4"	101.60	6.625	168.28
9813-5200-1601	9813-5200-1602	6"	152.40	10.500	266.70

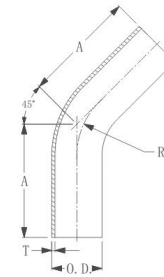

DT-4.1.1-4 焊式45度长弯头 Automatic Tube Weld: 45-deg Elbow

No.		Nom. Size		A	
SF1	SF4	in.	mm	in.	mm
9814-0600-1601	9814-0600-1602	1/4"	6.35	2.000	50.80
9814-0900-1601	9814-0900-1602	3/8"	9.53	2.000	50.80
9814-1200-1601	9814-1200-1602	1/2"	12.70	2.250	57.15
9814-1900-1601	9814-1900-1602	3/4"	19.05	2.250	57.15
9814-2500-1601	9814-2500-1602	1"	25.40	2.250	57.15
9814-3800-1601	9814-3800-1602	1 1/2"	38.10	2.500	63.50
9814-5000-1601	9814-5000-1602	2"	50.80	3.000	76.20
9814-6300-1601	9814-6300-1602	2 1/2"	63.50	3.375	85.73
9814-7600-1601	9814-7600-1602	3"	76.20	3.625	92.08
9814-0100-1601	9814-0100-1602	4"	101.60	4.500	114.30
9814-5200-1601	9814-5200-1602	6"	152.40	6.250	158.75

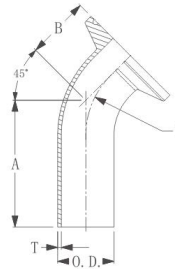

DT-4.1.1-5 单卡45度弯头 Automatic Tube Weld: Hygienic Clamp Joint, 45-deg Elbow

No.		Nom. Size		A		B	
SF1	SF4	in.	mm	in.	mm	in.	mm
9815-0600-1601	9815-0600-1602	1/4"	6.35	2.000	50.80	1.000	25.40
9815-0900-1601	9815-0900-1602	3/8"	9.53	2.000	50.80	1.000	25.40
9815-1200-1601	9815-1200-1602	1/2"	12.70	2.250	57.15	1.000	25.40
9815-1900-1601	9815-1900-1602	3/4"	19.05	2.250	57.15	1.000	25.40
9815-2500-1601	9815-2500-1602	1"	25.40	2.250	57.15	1.125	28.58
9815-3800-1601	9815-3800-1602	1 1/2"	38.10	2.500	63.50	1.438	36.53
9815-5000-1601	9815-5000-1602	2"	50.80	3.000	76.20	1.750	44.45
9815-6300-1601	9815-6300-1602	2 1/2"	63.50	3.375	85.73	2.063	52.40
9815-7600-1601	9815-7600-1602	3"	76.20	3.625	92.08	2.375	60.33
9815-0100-1601	9815-0100-1602	4"	101.60	4.500	114.30	3.125	79.38
9815-5200-1601	9815-5200-1602	6"	152.40	6.250	158.75	5.250	133.35

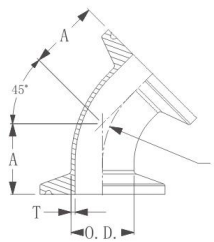

DT-4.1.1-6 卡式45度弯头 Hygienic Clamp Joint: 45-deg Elbow

No.		Nom. Size		A	
SF1	SF4	in.	mm	in.	mm
9816-0600-1601	9816-0600-1602	1/4"	6.35	1.000	25.40
9816-0900-1601	9816-0900-1602	3/8"	9.53	1.000	25.40
9816-1200-1601	9816-1200-1602	1/2"	12.70	1.000	25.40
9816-1900-1601	9816-1900-1602	3/4"	19.05	1.000	25.40
9816-2500-1601	9816-2500-1602	1"	25.40	1.125	28.58
9816-3800-1601	9816-3800-1602	1 1/2"	38.10	1.438	36.53
9816-5000-1601	9816-5000-1602	2"	50.80	1.750	44.45
9816-6300-1601	9816-6300-1602	2 1/2"	63.50	2.063	52.40
9816-7600-1601	9816-7600-1602	3"	76.20	2.375	60.33
9816-0100-1601	9816-0100-1602	4"	101.60	3.125	79.38
9816-5200-1601	9816-5200-1602	6"	152.40	5.250	133.35

BPE 管件系列

BPE Pipe Fittings Series

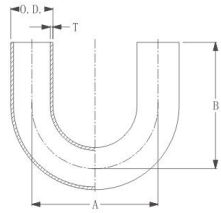

DT-4.1.1-7 焊式U型弯 Automatic Tube Weld: 180-deg Return Bend

No.		Nom. Size		A		B	
SF1	SF4	in.	mm	in.	mm	in.	mm
9817-0600-1601	9817-0600-1602	1/4"	6.35	4.500	114.30	2.625	66.68
9817-0900-1601	9817-0900-1602	3/8"	9.53	4.500	114.30	2.625	66.68
9817-1200-1601	9817-1200-1602	1/2"	12.70	4.500	114.30	3.000	76.20
9817-1900-1601	9817-1900-1602	3/4"	19.05	4.500	114.30	3.000	76.20
9817-2500-1601	9817-2500-1602	1"	25.40	3.000	76.20	3.000	76.20
9817-3800-1601	9817-3800-1602	1 1/2"	38.10	4.500	114.30	4.500	114.30
9817-5000-1601	9817-5000-1602	2"	50.80	6.000	152.40	5.000	127.00
9817-6300-1601	9817-6300-1602	2 1/2"	63.50	7.500	190.50	5.750	146.05
9817-7600-1601	9817-7600-1602	3"	76.20	9.000	228.60	6.500	165.10
9817-0100-1601	9817-0100-1602	4"	101.60	12.000	304.80	8.500	215.90
9817-5200-1601	9817-5200-1602	6"	152.40	18.000	457.20	11.500	292.10

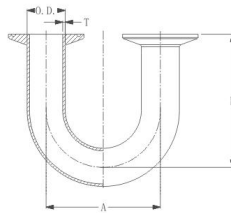

DT-4.1.1-8 卡式U型弯 Hygienic Clamp Joint: 180-deg Return Bend

No.		Nom. Size		A		B	
SF1	SF4	in.	mm	in.	mm	in.	mm
9818-0600-1601	9818-0600-1602	1/4"	6.35	4.500	114.30	3.125	79.38
9818-0900-1601	9818-0900-1602	3/8"	9.53	4.500	114.30	3.125	79.38
9818-1200-1601	9818-1200-1602	1/2"	12.70	4.500	114.30	3.500	88.90
9818-1900-1601	9818-1900-1602	3/4"	19.05	4.500	114.30	3.500	88.90
9818-2500-1601	9818-2500-1602	1"	25.40	3.000	76.20	3.500	88.90
9818-3800-1601	9818-3800-1602	1 1/2"	38.10	4.500	114.30	5.000	127.00
9818-5000-1601	9818-5000-1602	2"	50.80	6.000	152.40	5.500	139.70
9818-6300-1601	9818-6300-1602	2 1/2"	63.50	7.500	190.50	6.250	158.75
9818-7600-1601	9818-7600-1602	3"	76.20	9.000	228.60	7.000	177.80
9818-0100-1601	9818-0100-1602	4"	101.60	12.000	304.80	9.125	231.78
9818-5200-1601	9818-5200-1602	6"	152.40	18.000	457.20	13.000	330.20

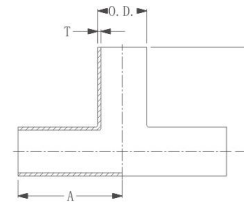

DT-4.1.2-1 焊式同径三通 Automatic Tube Weld: Straight Tee

No.		Nom. Size		A	
SF1	SF4	in.	mm	in.	mm
9819-0600-1601	9819-0600-1602	1/4"	6.35	1.750	44.45
9819-0900-1601	9819-0900-1602	3/8"	9.53	1.750	44.45
9819-1200-1601	9819-1200-1602	1/2"	12.70	1.875	47.63
9819-1900-1601	9819-1900-1602	3/4"	19.05	2.000	50.80
9819-2500-1601	9819-2500-1602	1"	25.40	2.125	53.98
9819-3800-1601	9819-3800-1602	1 1/2"	38.10	2.375	60.33
9819-5000-1601	9819-5000-1602	2"	50.80	2.875	73.03
9819-6300-1601	9819-6300-1602	2 1/2"	63.50	3.125	79.38
9819-7600-1601	9819-7600-1602	3"	76.20	3.375	85.73
9819-0100-1601	9819-0100-1602	4"	101.60	4.125	104.78
9819-5200-1601	9819-5200-1602	6"	152.40	5.625	142.88

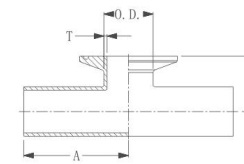

DT-4.1.2-2 单卡同径短三通 Automatic Tube Weld: Short-Outlet Hygienic Clamp Joint Tee

No.		Nom. Size		A		B	
SF1	SF4	in.	mm	in.	mm	in.	mm
9820-0600-1601	9820-0600-1602	1/4"	6.35	1.750	44.45	1.000	25.40
9820-0900-1601	9820-0900-1602	3/8"	9.53	1.750	44.45	1.000	25.40
9820-1200-1601	9820-1200-1602	1/2"	12.70	1.875	47.63	1.000	25.40
9820-1900-1601	9820-1900-1602	3/4"	19.05	2.000	50.80	1.125	28.58
9820-2500-1601	9820-2500-1602	1"	25.40	2.125	53.98	1.125	28.58
9820-3800-1601	9820-3800-1602	1 1/2"	38.10	2.375	60.33	1.375	34.93
9820-5000-1601	9820-5000-1602	2"	50.80	2.875	73.03	1.625	41.28
9820-6300-1601	9820-6300-1602	2 1/2"	63.50	3.125	79.38	1.875	47.63
9820-7600-1601	9820-7600-1602	3"	76.20	3.375	85.73	2.125	53.98
9820-0100-1601	9820-0100-1602	4"	101.60	4.125	104.78	2.750	69.85
9820-5200-1601	9820-5200-1602	6"	152.40	5.625	142.88	4.625	117.48

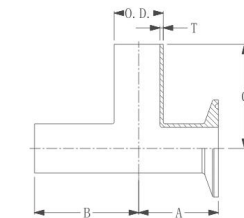

DT-4.1.2-3 L型仪表三通 Hygienic Mechanical Joint: Short-Outlet Run Tee

No.		Nom. Size		A		B		C	
SF1	SF4	in.	mm	in.	mm	in.	mm	in.	mm
9821-0600-1601	9821-0600-1602	1/4"	6.35	0.875	22.23	1.750	44.45	1.750	44.45
9821-0900-1601	9821-0900-1602	3/8"	9.53	0.875	22.23	1.750	44.45	1.750	44.45
9821-1200-1601	9821-1200-1602	1/2"	12.70	0.875	22.23	1.875	47.63	1.875	47.63
9821-1900-1601	9821-1900-1602	3/4"	19.05	1.000	25.40	2.000	50.80	2.000	50.80
9821-2500-1601	9821-2500-1602	1"	25.40	1.125	28.58	2.125	53.98	2.125	53.98
9821-3800-1601	9821-3800-1602	1 1/2"	38.10	1.375	34.93	2.375	60.33	2.375	60.33
9821-5000-1601	9821-5000-1602	2"	50.80	1.625	41.28	2.875	73.03	2.875	73.03
9821-6300-1601	9821-6300-1602	2 1/2"	63.50	1.875	47.63	3.125	79.38	3.125	79.38
9821-7600-1601	9821-7600-1602	3"	76.20	2.125	53.98	3.375	85.73	3.375	85.73
9821-0100-1601	9821-0100-1602	4"	101.60	2.750	69.85	4.125	104.78	4.125	104.78
9821-5200-1601	9821-5200-1602	6"	152.40	4.625	117.48	5.625	142.88	5.625	142.88

BPE 管件系列

BPE Pipe Fittings Series



DT-4.1.2-4 卡式同径长三通 Hygienic Clamp Joint: Straight Tee

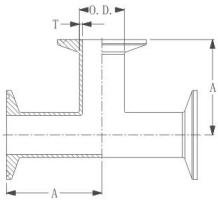

No.		Nom. Size		A	
SF1	SF4	in.	mm	in.	mm
9822-0600-1601	9822-0600-1602	1/4"	6.35	2.250	57.15
9822-0900-1601	9822-0900-1602	3/8"	9.53	2.250	57.15
9822-1200-1601	9822-1200-1602	1/2"	12.70	2.375	60.33
9822-1900-1601	9822-1900-1602	3/4"	19.05	2.500	63.50
9822-2500-1601	9822-2500-1602	1"	25.40	2.625	66.68
9822-3800-1601	9822-3800-1602	1 1/2"	38.10	2.875	73.03
9822-5000-1601	9822-5000-1602	2"	50.80	3.375	85.73
9822-6300-1601	9822-6300-1602	2 1/2"	63.50	3.625	92.08
9822-7600-1601	9822-7600-1602	3"	76.20	3.875	98.43
9822-0100-1601	9822-0100-1602	4"	101.60	4.750	120.65
9822-5200-1601	9822-5200-1602	6"	152.40	7.125	180.98

DT-4.1.2-5 卡式同径短三通 Hygienic Clamp Joint: Short-Outlet Tee

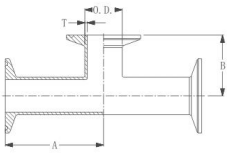

No.		Nom. Size		A		B	
SF1	SF4	in.	mm	in.	mm	in.	mm
9823-1200-1601	9823-1200-1602	1/2"	12.70	2.375	60.33	1.000	25.40
9823-1900-1601	9823-1900-1602	3/4"	19.05	2.500	63.50	1.125	28.58
9823-2500-1601	9823-2500-1602	1"	25.40	2.625	66.68	1.125	28.58
9823-3800-1601	9823-3800-1602	1 1/2"	38.10	2.875	73.03	1.375	34.93
9823-5000-1601	9823-5000-1602	2"	50.80	3.375	85.73	1.625	41.28
9823-6300-1601	9823-6300-1602	2 1/2"	63.50	3.625	92.08	1.875	47.63
9823-7600-1601	9823-7600-1602	3"	76.20	3.875	98.43	2.125	53.98
9823-0100-1601	9823-0100-1602	4"	101.60	4.750	120.65	2.750	69.85
9823-5200-1601	9823-5200-1602	6"	152.40	7.125	180.98	4.625	117.48

DT-4.1.2-6 焊式异径三通 Automatic Tube Weld: Reducing Tee

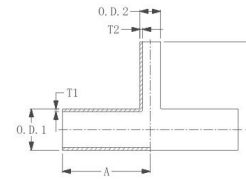

No.		Nom. Size		A		B	
SF1	SF4	in.	mm	in.	mm	in.	mm
9824-0906-1601	9824-0906-1602	3/8" x 1/4"	9.53 x 6.35	1.750	44.45	1.750	44.45
9824-1206-1601	9824-1206-1602	1/2" x 1/4"	12.7 x 6.35	1.875	47.63	1.875	47.63
9824-1209-1601	9824-1209-1602	1/2" x 3/8"	12.7 x 9.53	1.875	47.63	1.875	47.63
9824-1906-1601	9824-1906-1602	3/4" x 1/4"	19.05 x 6.35	2.000	50.80	2.000	50.80
9824-1909-1601	9824-1909-1602	3/4" x 3/8"	19.05 x 9.53	2.000	50.80	2.000	50.80
9824-1912-1601	9824-1912-1602	3/4" x 1/2"	19.05 x 12.7	2.000	50.80	2.000	50.80
9824-2506-1601	9824-2506-1602	1" x 1/4"	25.4 x 6.35	2.125	53.98	2.125	53.98
9824-2509-1601	9824-2509-1602	1" x 3/8"	25.4 x 9.53	2.125	53.98	2.125	53.98
9824-2512-1601	9824-2512-1602	1" x 1/2"	25.4 x 12.7	2.125	53.98	2.125	53.98
9824-2519-1601	9824-2519-1602	1" x 3/4"	25.4 x 19.05	2.125	53.98	2.125	53.98
9824-3812-1601	9824-3812-1602	1 1/2" x 1/2"	38.1 x 12.7	2.375	60.33	2.375	60.33
9824-3819-1601	9824-3819-1602	1 1/2" x 3/4"	38.1 x 19.05	2.375	60.33	2.375	60.33
9824-3825-1601	9824-3825-1602	1 1/2" x 1"	38.1 x 25.4	2.375	60.33	2.375	60.33
9824-5012-1601	9824-5012-1602	2" x 1/2"	50.8 x 12.7	2.875	73.03	2.625	66.68
9824-5019-1601	9824-5019-1602	2" x 3/4"	50.8 x 19.05	2.875	73.03	2.625	66.68
9824-5025-1601	9824-5025-1602	2" x 1"	50.8 x 25.4	2.875	73.03	2.625	66.68
9824-5038-1601	9824-5038-1602	2" x 1 1/2"	50.8 x 38.1	2.875	73.03	2.625	66.68
9824-6312-1601	9824-6312-1602	2 1/2" x 1/2"	63.5 x 12.7	3.125	79.38	2.875	73.03
9824-6319-1601	9824-6319-1602	2 1/2" x 3/4"	63.5 x 19.05	3.125	79.38	2.875	73.03
9824-6325-1601	9824-6325-1602	2 1/2" x 1"	63.5 x 25.4	3.125	79.38	2.875	73.03
9824-6338-1601	9824-6338-1602	2 1/2" x 1 1/2"	63.5 x 38.1	3.125	79.38	2.875	73.03
9824-6350-1601	9824-6350-1602	2 1/2" x 2"	63.5 x 50.8	3.125	79.38	2.875	73.03
9824-7612-1601	9824-7612-1602	3" x 1/2"	76.2 x 12.7	3.375	85.73	3.125	79.38
9824-7619-1601	9824-7619-1602	3" x 3/4"	76.2 x 19.05	3.375	85.73	3.125	79.38
9824-7625-1601	9824-7625-1602	3" x 1"	76.2 x 25.4	3.375	85.73	3.125	79.38
9824-7638-1601	9824-7638-1602	3" x 1 1/2"	76.2 x 38.1	3.375	85.73	3.125	79.38
9824-7650-1601	9824-7650-1602	3" x 2"	76.2 x 50.8	3.375	85.73	3.125	79.38
9824-7663-1601	9824-7663-1602	3" x 2 1/2"	76.2 x 63.5	3.375	85.73	3.125	79.38
9824-0112-1601	9824-0112-1602	4" x 1/2"	101.6 x 12.7	4.125	104.78	3.625	92.08
9824-0119-1601	9824-0119-1602	4" x 3/4"	101.6 x 19.05	4.125	104.78	3.625	92.08
9824-0125-1601	9824-0125-1602	4" x 1"	101.6 x 25.4	4.125	104.78	3.625	92.08
9824-0138-1601	9824-0138-1602	4" x 1 1/2"	101.6 x 38.1	4.125	104.78	3.625	92.08
9824-0150-1601	9824-0150-1602	4" x 2"	101.6 x 50.8	4.125	104.78	3.875	98.43
9824-0163-1601	9824-0163-1602	4" x 2 1/2"	101.6 x 63.5	4.125	104.78	3.875	98.43
9824-0176-1601	9824-0176-1602	4" x 3"	101.6 x 76.2	4.125	104.78	3.875	98.43
9824-5212-1601	9824-5212-1602	6" x 1/2"	152.4 x 12.7	5.625	142.88	4.625	117.48
9824-5219-1601	9824-5219-1602	6" x 3/4"	152.4 x 19.05	5.625	142.88	4.625	117.48
9824-5225-1601	9824-5225-1602	6" x 1"	152.4 x 25.4	5.625	142.88	4.625	117.48
9824-5238-1601	9824-5238-1602	6" x 1 1/2"	152.4 x 38.1	5.625	142.88	4.625	117.48
9824-5250-1601	9824-5250-1602	6" x 2"	152.4 x 50.8	5.625	142.88	4.875	123.83
9824-5263-1601	9824-5263-1602	6" x 2 1/2"	152.4 x 63.5	5.625	142.88	4.875	123.83
9824-5276-1601	9824-5276-1602	6" x 3"	152.4 x 76.2	5.625	142.88	4.875	123.83
9824-5201-1601	9824-5201-1602	6" x 4"	152.4 x 101.6	5.625	142.88	5.125	130.18

BPE 管件系列

BPE Pipe Fittings Series

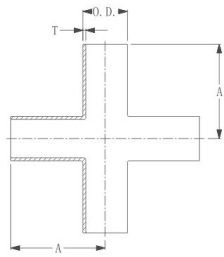

DT-4.1.2-1 焊式同径四通 Automatic Tube Weld: Straight Cross

No.		Nom. Size		A	
SF1	SF4	in.	mm	in.	mm
9838-0600-1601	9838-0600-1602	1/4"	6.35	1.750	44.45
9838-0900-1601	9838-0900-1602	3/8"	9.53	1.750	44.45
9838-1200-1601	9838-1200-1602	1/2"	12.70	1.875	47.63
9838-1900-1601	9838-1900-1602	3/4"	19.05	2.000	50.80
9838-2500-1601	9838-2500-1602	1"	25.40	2.125	53.98
9838-3800-1601	9838-3800-1602	1 1/2"	38.10	2.375	60.33
9838-5000-1601	9838-5000-1602	2"	50.80	2.875	73.03
9838-6300-1601	9838-6300-1602	2 1/2"	63.50	3.125	79.38
9838-7600-1601	9838-7600-1602	3"	76.20	3.375	85.73
9838-0100-1601	9838-0100-1602	4"	101.60	4.125	104.78
9838-5200-1601	9838-5200-1602	6"	152.40	5.625	142.88

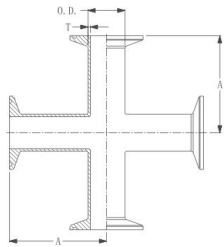

DT-4.1.2-4 卡式同径四通 Hygienic Clamp Joint: Straight Cross

No.		Nom. Size		A	
SF1	SF4	in.	mm	in.	mm
9840-0600-1601	9840-0600-1602	1/4"	6.35	2.250	57.15
9840-0900-1601	9840-0900-1602	3/8"	9.53	2.250	57.15
9840-1200-1601	9840-1200-1602	1/2"	12.70	2.375	60.33
9840-1900-1601	9840-1900-1602	3/4"	19.05	2.500	63.50
9840-2500-1601	9840-2500-1602	1"	25.40	2.625	66.68
9840-3800-1601	9840-3800-1602	1 1/2"	38.10	2.875	73.03
9840-5000-1601	9840-5000-1602	2"	50.80	3.375	85.73
9840-6300-1601	9840-6300-1602	2 1/2"	63.50	3.625	92.08
9840-7600-1601	9840-7600-1602	3"	76.20	3.875	98.43
9840-0100-1601	9840-0100-1602	4"	101.60	4.750	120.65
9840-5200-1601	9840-5200-1602	6"	152.40	7.125	180.98

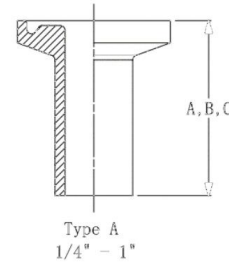

Type A
1/4" - 1"

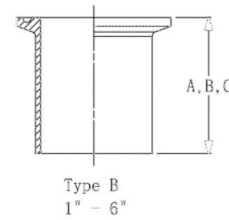

Type B
1" - 6"

DT-4.1.4-1 接头1 Automatic Tube Weld: Ferrule

No.		Nom. Size		A	
SF1	SF4	in.	mm	in.	mm
9941-0600-1601	9941-0600-1602	1/4"	6.35	1.750	44.45
9941-0900-1601	9941-0900-1602	3/8"	9.53	1.750	44.45
9941-1200-1601	9941-1200-1602	1/2"	12.70	1.750	44.45
9941-1900-1601	9941-1900-1602	3/4"	19.05	1.750	44.45
9941-2500-1601	9941-2500-1602	1"	25.40	1.750	44.45
9941-3800-1601	9941-3800-1602	1 1/2"	38.10	1.750	44.45
9941-5000-1601	9941-5000-1602	2"	50.80	2.250	57.15
9941-6300-1601	9941-6300-1602	2 1/2"	63.50	2.250	57.15
9941-7600-1601	9941-7600-1602	3"	76.20	2.250	57.15
9941-0100-1601	9941-0100-1602	4"	101.60	2.250	57.15
9941-5200-1601	9941-5200-1602	6"	152.40	3.000	76.20

DT-4.1.4-2 接头2 Automatic Tube Weld: Ferrule

No.		Nom. Size		A	
SF1	SF4	in.	mm	in.	mm
9942-0600-1601	9942-0600-1602	1/4"	6.35	1.125	28.58
9942-0900-1601	9942-0900-1602	3/8"	9.53	1.125	28.58
9942-1200-1601	9942-1200-1602	1/2"	12.70	1.125	28.58
9942-1900-1601	9942-1900-1602	3/4"	19.05	1.125	28.58
9942-2500-1601	9942-2500-1602	1"	25.40	1.125	28.58
9942-3800-1601	9942-3800-1602	1 1/2"	38.10	1.125	28.58
9942-5000-1601	9942-5000-1602	2"	50.80	1.125	28.58
9942-6300-1601	9942-6300-1602	2 1/2"	63.50	1.125	28.58
9942-7600-1601	9942-7600-1602	3"	76.20	1.125	28.58
9942-0100-1601	9942-0100-1602	4"	101.60	1.125	28.58
9942-5200-1601	9942-5200-1602	6"	152.40	1.500	38.10

DT-4.1.4-3 接头3 Automatic Tube Weld: Ferrule

No.		Nom. Size		A	
SF1	SF4	in.	mm	in.	mm
9943-0600-1601	9943-0600-1602	1/4"	6.35	0.500	12.70
9943-0900-1601	9943-0900-1602	3/8"	9.53	0.500	12.70
9943-1200-1601	9943-1200-1602	1/2"	12.70	0.500	12.70
9943-1900-1601	9943-1900-1602	3/4"	19.05	0.500	12.70
9943-2500-1601	9943-2500-1602	1"	25.40	0.500	12.70
9943-3800-1601	9943-3800-1602	1 1/2"	38.10	0.500	12.70
9943-5000-1601	9943-5000-1602	2"	50.80	0.500	12.70
9943-6300-1601	9943-6300-1602	2 1/2"	63.50	0.500	12.70
9943-7600-1601	9943-7600-1602	3"	76.20	0.500	12.70
9943-0100-1601	9943-0100-1602	4"	101.60	0.622	15.80
9943-5200-1601	9943-5200-1602	6"	152.40	0.750	19.05

BPE 管件系列

BPE Pipe Fittings Series

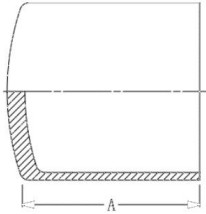

DT-4.1.5-1 端盖 Automatic Tube Weld: Cap

No.		Nom. Size		A	
SF1	SF4	in.	mm	in.	mm
9951-1200-1601	9951-1200-1602	1/2"	12.70	1.500	38.10
9951-1900-1601	9951-1900-1602	3/4"	19.05	1.500	38.10
9951-2500-1601	9951-2500-1602	1"	25.40	1.500	38.10
9951-3800-1601	9951-3800-1602	1 1/2"	38.10	1.500	38.10
9951-5000-1601	9951-5000-1602	2"	50.80	1.500	38.10
9951-6300-1601	9951-6300-1602	2 1/2"	63.50	1.500	38.10
9951-7600-1601	9951-7600-1602	3"	76.20	1.750	44.45
9951-0100-1601	9951-0100-1602	4"	101.60	2.000	50.80
9951-5200-1601	9951-5200-1602	6"	152.40	2.500	63.50

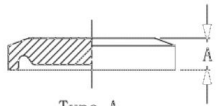

Type A
1/4" - 1"

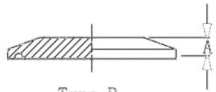

Type B
1" - 6"

DT-4.1.5-2 盲盖 Hygienic Clamp Joint: Solid End Cap

No.		Nom. Size		A	
SF1	SF4	in.	mm	in.	mm
9952-0600-1601	9952-0600-1602	1/4"	6.35	0.187	4.75
9952-0900-1601	9952-0900-1602	3/8"	9.53	0.187	4.75
9952-1200-1601	9952-1200-1602	1/2"	12.70	0.187	4.75
9952-1900-1601	9952-1900-1602	3/4"	19.05	0.187	4.75
9952-2500-1601	9952-2500-1602	1"	25.40	0.250	6.35
9952-3800-1601	9952-3800-1602	1 1/2"	38.10	0.250	6.35
9952-5000-1601	9952-5000-1602	2"	50.80	0.250	6.35
9952-6300-1601	9952-6300-1602	2 1/2"	63.50	0.250	6.35
9952-7600-1601	9952-7600-1602	3"	76.20	0.250	6.35
9952-0100-1601	9952-0100-1602	4"	101.60	0.312	7.92
9952-5200-1601	9952-5200-1602	6"	152.40	0.437	11.10